

## PREFERED MACHINE LAYOUT

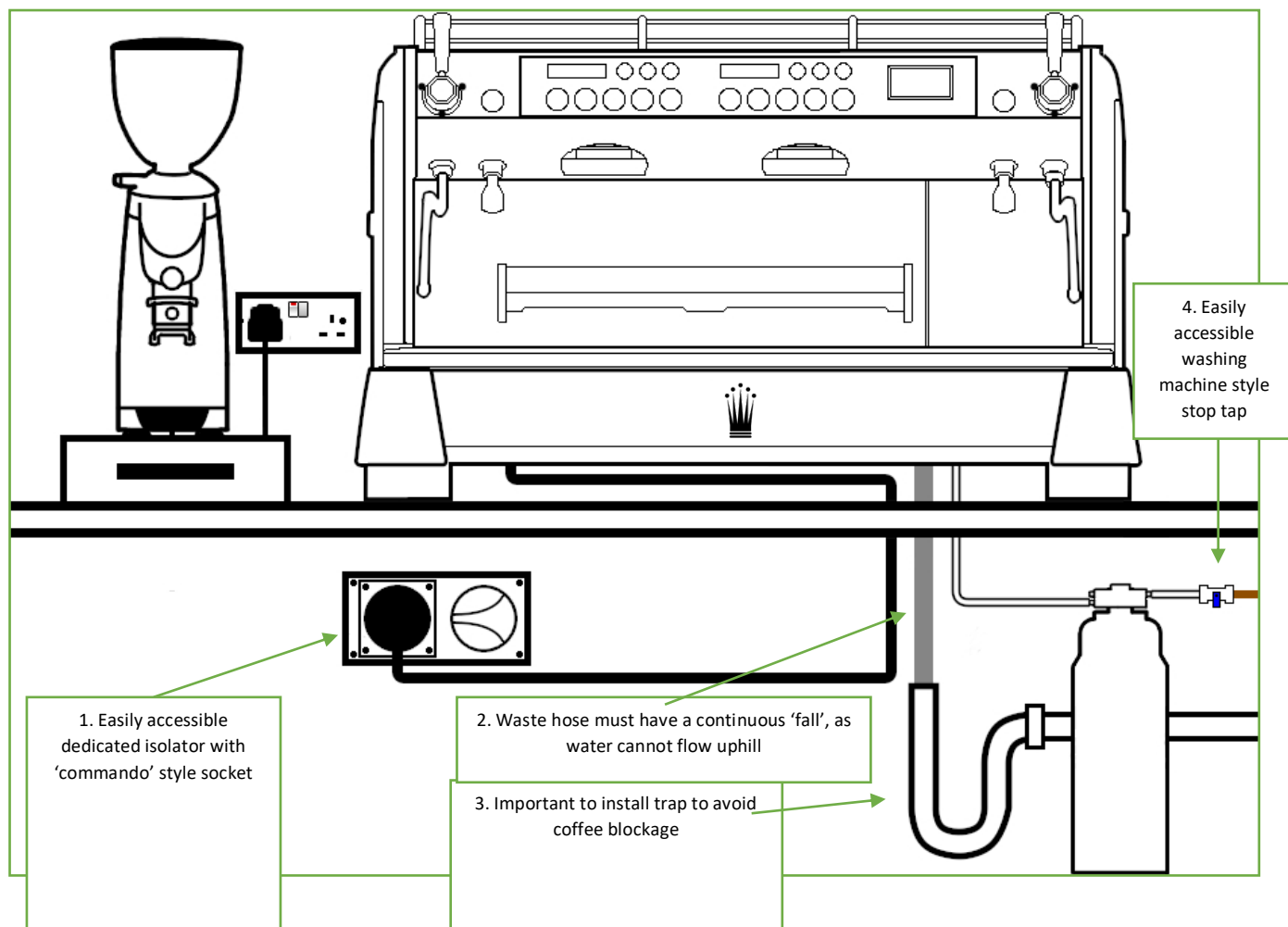

MODEL	GROUPS	BOILER SIZE	TOTAL ELECTRICAL LOAD	RECOMMENDED BREAKER
MONTE CARLO	2	10L 2 x 0.9L	4200W 2 x 100W	32A
MONTE CARLO	3	14L 3 x 0.9L	6000W 3 x 100W	32A

- Dedicated electrical Supply within 1 metre of final machine location. See table below.
- Dedicated cold water supply terminating within 1 metre of machine location, fitted with ¾" washing machine shut off valve.
- Straight upstand and u-bend to be fitted directly under machine, below counter (If no plumbed in waste, please make sure suitable container available to collect waste water)
- Both electrical and plumbing services tested
- 13A three pin socket for grinder installed above counter
- Space under counter clear (remove fridge/dishwasher etc) for access to water, waste & power supply. Space also required for water treatment unit 525mm H x 175mm c ø
- Minimum of 70mm ø hole to drilled in counter to accept waste and water feed (Installation Engineer can only drill soft wood surfaces by prior arrangement only)
- Someone on site to assist with lifting the equipment
- Space for 'work area' as per above diagram, with a worktop that can support 150kg minimum
- Coffee, cups and milk onsite for calibration

**I understand that by signing the above I can confirm all the information is correct. Should any of the above not be fulfilled I understand this may result in additional costs or an aborted installation charge of £150.00+vat. Any grey areas or questions, please contact us on the number below. We welcome site ready photos.**

**Name** \_\_\_\_\_ **Signature** \_\_\_\_\_ **Date** \_\_\_\_ / \_\_\_\_ / \_\_\_\_